

Scenic Ruby & Pearl

▶ Take a 360° Tour @ scenicusa.com

Refurbished 2019 | Built 2009/2011 | Length 443 feet | Passengers 159 | Cabins 80 | Crew 59 | Gross tonnage 2,721

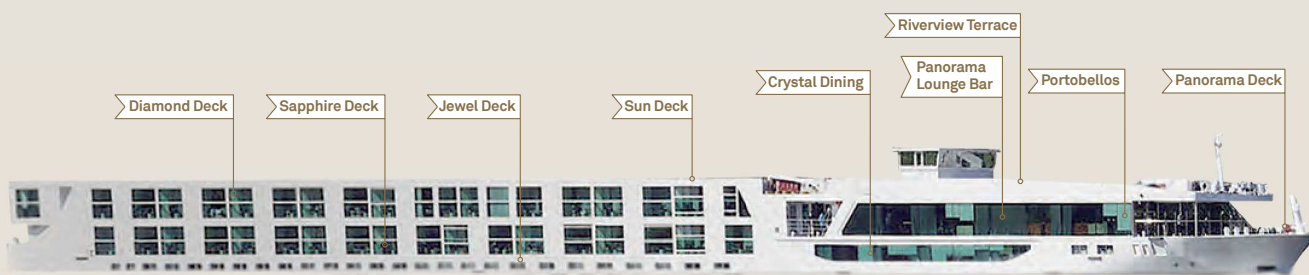

Sun Deck



Deck Plan

- 1 Riverview Terrace
- 2 Wheelhouse
- 3 Sun Deck
- 4 Walking Track
- 5 Panorama Deck
- 6 Portobellos Restaurant
- 7 River Café
- 8 Panorama Lounge & Bar
- 9 Gift Shop
- 10 Reception
- 11 Elevator
- 12 Crystal Dining
- 13 Table La Rive
- 14 Galley
- 15 Wellness Area
- 16 Salt Therapy Lounge
- 17 Hairdresser
- 18 Fitness Center

Diamond Deck



Sapphire Deck

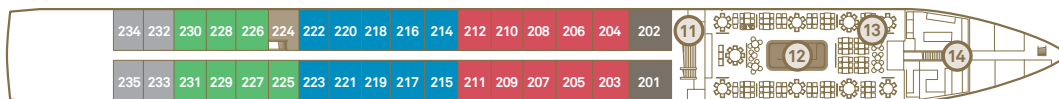

Jewel Deck

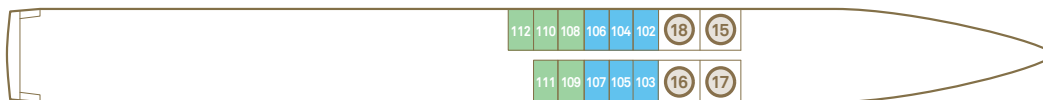

Suite Categories

Diamond Deck		Sapphire Deck	
RS	Royal Panorama Suite	C	Balcony Suite
A	Balcony Suite	BA	Balcony Suite
PA	Balcony Suite	BS	Single Balcony Suite
PP	Balcony Suite	BB	Balcony Suite
RA	Royal Balcony Suite	B	Balcony Suite
R	Royal Balcony Suite	BJ	Junior Balcony Suite
RO	Royal Owner's Suite	Jewel Deck	
P	Balcony Suite	E	Standard Suite
RJ	Junior Balcony Suite	D	Standard Suite

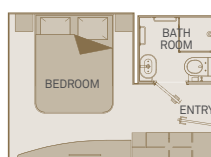

Standard Suite

160ft²

E D

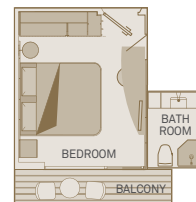

Private Balcony Suite

205ft²

Including Scenic Sun Lounge

A PA PP P C BA BB B

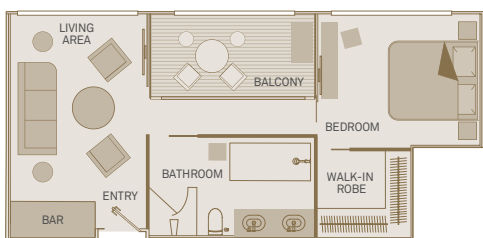

Royal Owner's Suite

520ft²

One bedroom suite including Scenic Sun Lounge

RO

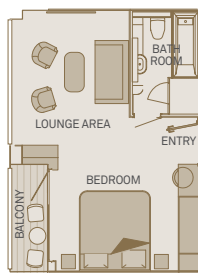

Royal Balcony Suite

315ft²

Including Scenic Sun Lounge

R

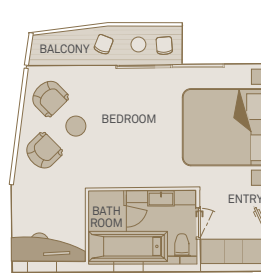

Royal Panorama Suite

325ft²

Including Scenic Sun Lounge

RS

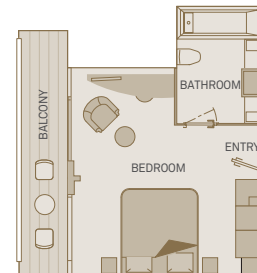

Junior Balcony Suite

250ft²

Including Scenic Sun Lounge

RJ BJ

The deckplan and cabin layout images are an indication only and may vary. Please refer to scenicusa.com for further information. Scenic Pearl Balcony Suites 303 and 304 are RJ Balcony Suites.