

Scenic Jasper, Opal & Amber

▶ Take a 360° Tour @ scenicusa.com

Refurbished 2019 | Built 2015/2016 | Length 443 feet | Passengers 163 | Cabins 82 | Crew 59 | Gross tonnage 2,721

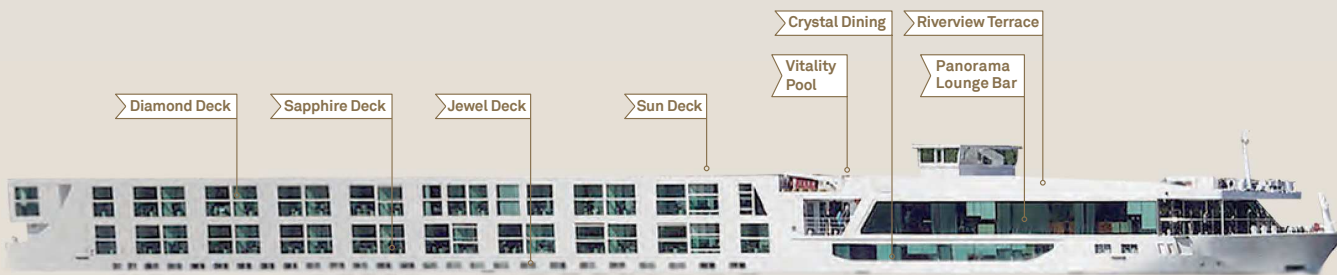

Sun Deck



Diamond Deck

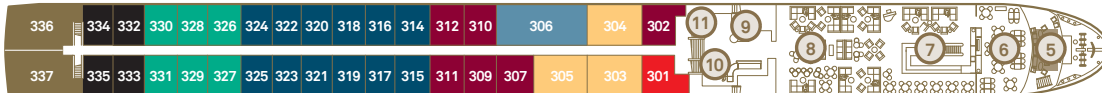

Sapphire Deck

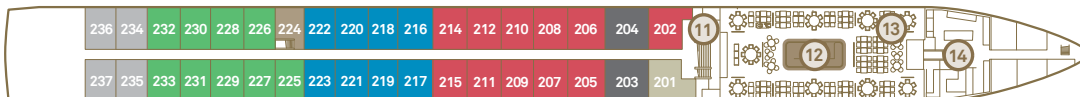

Jewel Deck

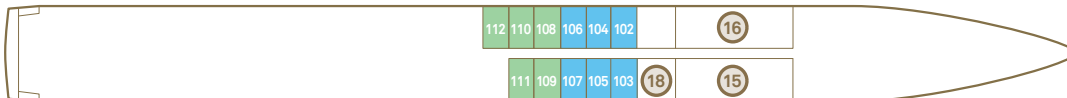

Deck Plan

- 1 Riverview Terrace
- 2 Wheelhouse
- 3 Sun Deck
- 4 Walking Track
- 5 Panorama Deck
- 6 Portobellos Restaurant
- 7 River Café
- 8 Lounge & Bar
- 9 Gift Shop
- 10 Reception
- 11 Elevator
- 12 Crystal Dining
- 13 Table La Rive
- 14 Galley
- 15 Wellness Area
- 16 Fitness Center
- 17 Vitality Pool
- 18 Salt Therapy Lounge

Suite Categories

Diamond Deck

RP	Royal Panorama Suite	C	Balcony Suite
A	Balcony Suite	BA	Balcony Suite
PA	Balcony Suite	BS	Single Balcony Suite
PP	Balcony Suite	BB	Balcony Suite
PD	Deluxe Balcony Suite	BD	Deluxe Balcony Suite
RR	Royal Balcony Suite	BJ	Junior Balcony Suite
RO	Royal Owner's Suite	B1J	Junior Balcony Suite
RJ	Junior Balcony Suite		

Sapphire Deck

C	Balcony Suite
BA	Balcony Suite
BS	Single Balcony Suite
BB	Balcony Suite
BD	Deluxe Balcony Suite
BJ	Junior Balcony Suite
B1J	Junior Balcony Suite

Jewel Deck

E	Standard Suite
D	Standard Suite

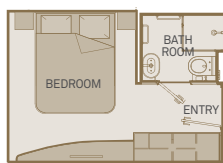

Standard Suite

160ft²

E D

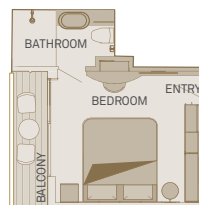

Private Balcony Suite

205ft²

Including Scenic Sun Lounge

A PA PP C BA BB

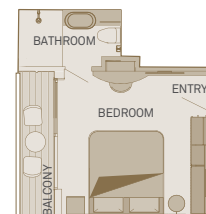

Private Deluxe Balcony Suite

21m²/225ft²

Including Scenic Sun Lounge

PD BD

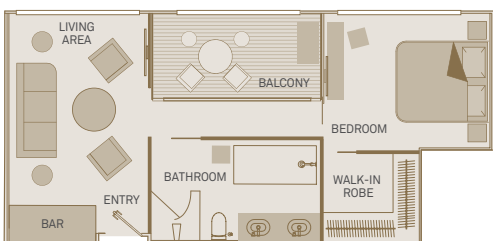

Royal Owner's Suite

520ft²

One bedroom suite including Scenic Sun Lounge

RO

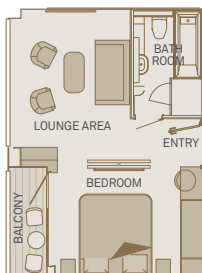

Royal Balcony Suite

360ft²

Including Scenic Sun Lounge

RR

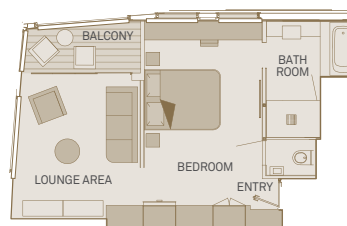

Royal Panorama Suite

475ft²

Including Scenic Sun Lounge

RP

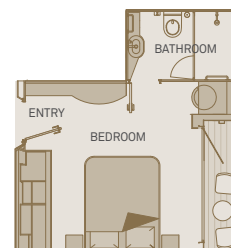

Junior Suite

250ft²

Including Scenic Sun Lounge

BJ

The deckplan and cabin layout images are an indication only and may vary. Please refer to scenicusa.com for further information.