

# ROTTERDAM

## DECK PLANS & STATEROOMS

The deck plans are color-coded by category of stateroom, and the category letter precedes the stateroom number in each room. All staterooms are equipped with flat-panel television, DVD player, telephone and multichannel music.

**Important Note:** Not all staterooms within each category have the same furniture configuration and/or facilities. Appropriate symbols within the rooms on the deck plans describe differences from the stateroom descriptions below.

All information is subject to change.

### STATEROOM SYMBOL LEGEND

- Quad (2 lower beds, 1 sofa bed, 1 upper)
- Triple (2 lower beds, 1 sofa bed)
- ▲ 2 lower beds or converts to 1 queen-size
- △ Partial sea view
- X Fully obstructed view
- \* Shower only
- Bathtub & shower
- + Connecting rooms
- ◇ These staterooms have portholes instead of windows

### ACCESSIBILITY STATEROOM SYMBOL LEGEND

- ♿ Suites AA7061 & AA6223 and stateroom EE3437 are fully accessible, roll-in shower only
- ▼ Suites SB7041 & SB7040 are fully accessible with single side approach to the bed with bathtub & roll-in shower. Staterooms CQ6104, CA3333, CA3331, G1805 & G1804 are fully accessible with single side approach to the bed, roll-in shower only.
- ★ Staterooms HH3439, HH3428, H3399, H3394, E2709, E2704, E2702, L2696, J2555, J2554, G2500, FF1956, FF1943, G1807 & G1806 are ambulatory accessible, roll-in shower only

For more information regarding accessibility features on our ships please visit the [Accessible Cruising](#) section of our website.

### OCEAN-VIEW STATEROOMS

- D □ E □ EE □ F □ FF

**Large:** 2 lower beds convertible to 1 queen-size bed, bathtub & shower. Approximately 140–319 sq. ft.

### G

**Large:** 2 lower beds convertible to 1 queen-size bed, bathtub & shower. All G-category staterooms have portholes. Approximately 140–319 sq. ft.

### INTERIOR STATEROOMS

- J □ M □ MM □ N

**Large:** 2 lower beds convertible to 1 queen-size bed, shower. Approximately 182–293 sq. ft.

## DECK 1—DOLPHIN DECK

Staterooms 1800–1956

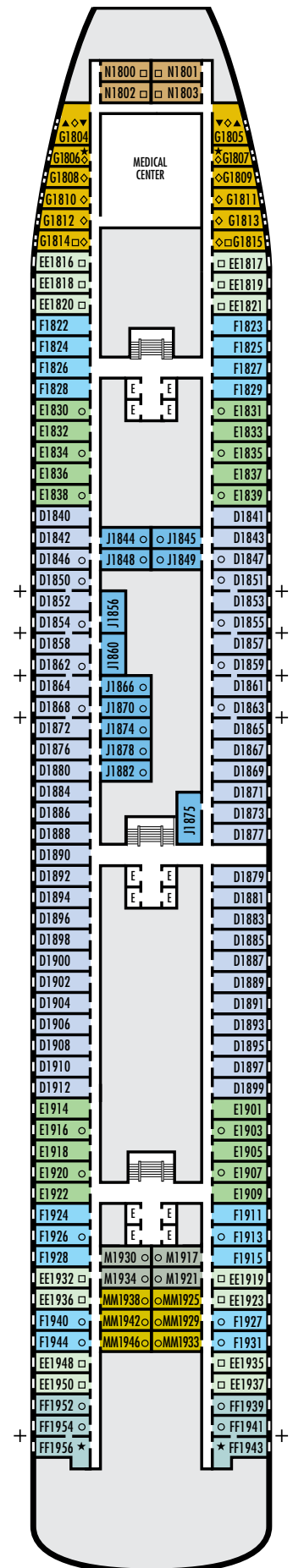

Dolphin Deck

# ROTTERDAM

## DECK PLANS & STATEROOMS

The deck plans are color-coded by category of stateroom, and the category letter precedes the stateroom number in each room. All staterooms are equipped with flat-panel television, DVD player, telephone and multichannel music.

**Important Note:** Not all staterooms within each category have the same furniture configuration and/or facilities. Appropriate symbols within the rooms on the deck plans describe differences from the stateroom descriptions below.

All information is subject to change.

### STATEROOM SYMBOL LEGEND

- Quad (2 lower beds, 1 sofa bed, 1 upper)
- Triple (2 lower beds, 1 sofa bed)
- ▲ 2 lower beds or converts to 1 queen-size
- △ Partial sea view
- × Fully obstructed view
- \* Shower only
- Bathtub & shower
- + Connecting rooms
- ◇ These staterooms have portholes instead of windows

### ACCESSIBILITY STATEROOM SYMBOL LEGEND

- ♿ Suites AA7061 & AA6223 and stateroom EE3437 are fully accessible, roll-in shower only
- ▼ Suites SB7041 & SB7040 are fully accessible with single side approach to the bed with bathtub & roll-in shower. Staterooms CQ6104, CA3333, CA3331, G1805 & G1804 are fully accessible with single side approach to the bed, roll-in shower only.
- ★ Staterooms HH3439, HH3428, H3399, H3394, E2709, E2704, E2702, L2696, J2555, J2554, G2500, FF1956, FF1943, G1807 & G1806 are ambulatory accessible, roll-in shower only

For more information regarding accessibility features on our ships please visit the [Accessible Cruising](#) section of our website.

### OCEAN-VIEW STATEROOMS

**C** **DA** **DD** **E**

**Large:** 2 lower beds convertible to 1 queen-size bed, bathtub & shower. Approximately 140–319 sq. ft.

**G**

**Large:** 2 lower beds convertible to 1 queen-size bed, bathtub & shower. All G-category staterooms have portholes. Approximately 140–319 sq. ft.

### INTERIOR STATEROOMS

**J** **K** **L** **M**

**Large:** 2 lower beds convertible to 1 queen-size bed, shower. Approximately 182–293 sq. ft.

## DECK 2—MAIN DECK

Staterooms 2500–2711

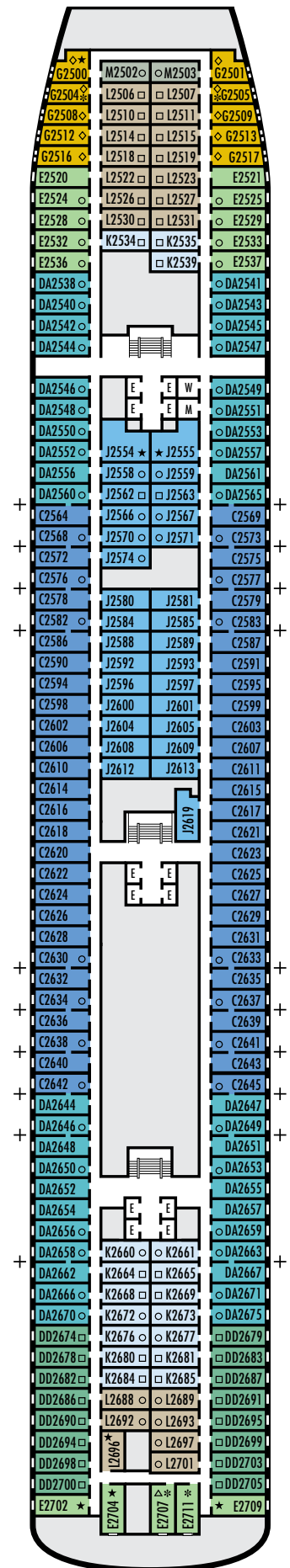

Main Deck



## ROTTERDAM

### DECK PLANS & STATEROOMS

The deck plans are color-coded by category of stateroom, and the category letter precedes the stateroom number in each room. All staterooms are equipped with flat-panel television, DVD player, telephone and multichannel music.

**Important Note:** Not all staterooms within each category have the same furniture configuration and/or facilities. Appropriate symbols within the rooms on the deck plans describe differences from the stateroom descriptions below.

All information is subject to change.

### STATEROOM SYMBOL LEGEND

- Quad (2 lower beds, 1 sofa bed, 1 upper)
- Triple (2 lower beds, 1 sofa bed)
- ▲ 2 lower beds or converts to 1 queen-size
- △ Partial sea view
- × Fully obstructed view
- \* Shower only
- Bathtub & shower
- + Connecting rooms
- ◇ These staterooms have portholes instead of windows

### ACCESSIBILITY STATEROOM SYMBOL LEGEND

- ♿ Suites AA7061 & AA6223 and stateroom EE3437 are fully accessible, roll-in shower only
- ▼ Suites SB7041 & SB7040 are fully accessible with single side approach to the bed with bathtub & roll-in shower. Staterooms CQ6104, CA3333, CA3331, G1805 & G1804 are fully accessible with single side approach to the bed, roll-in shower only.
- ★ Staterooms HH3439, HH3428, H3399, H3394, E2709, E2704, E2702, L2696, J2555, J2554, G2500, FF1956, FF1943, G1807 & G1806 are ambulatory accessible, roll-in shower only

For more information regarding accessibility features on our ships please visit the [Accessible Cruising](#) section of our website.

### OCEAN-VIEW STATEROOMS

#### CA

**Lanai:** 2 lower beds convertible to 1 queen-size bed, bathtub & shower. Sliding glass doors lead onto the walk-around Lower Promenade Deck. Approximately 196–240 sq. ft.

#### D EE

**Large:** 2 lower beds convertible to 1 queen-size bed, bathtub & shower. Approximately 140–319 sq. ft.

#### H HH

**Large:** 2 lower beds convertible to 1 queen-size bed, bathtub & shower. All H-category staterooms have partial sea views. All HH-category staterooms have fully obstructed views. Approximately 140–319 sq. ft.

### INTERIOR STATEROOMS

#### I L

**Large:** 2 lower beds convertible to 1 queen-size bed, shower. Approximately 182–293 sq. ft.



Lower Promenade Deck

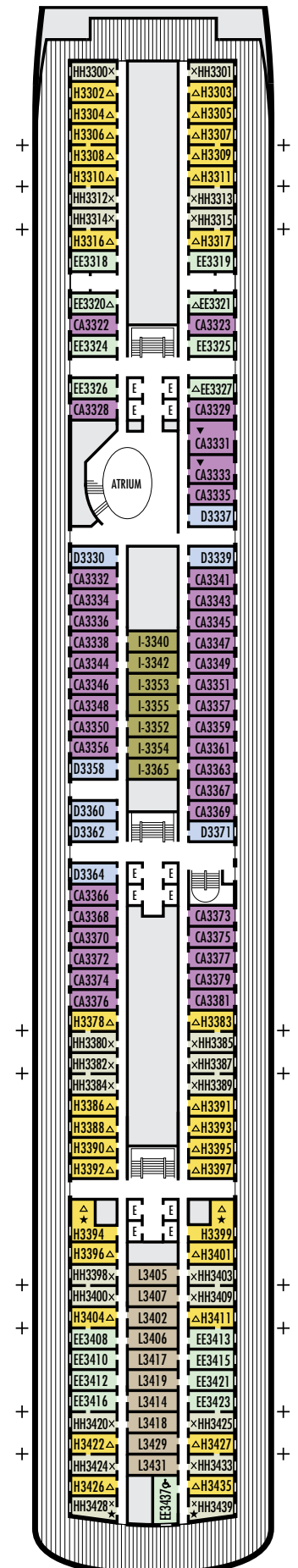

## ROTTERDAM

### DECK PLANS & STATEROOMS

The deck plans are color-coded by category of stateroom, and the category letter precedes the stateroom number in each room. All staterooms are equipped with flat-panel television, DVD player, telephone and multichannel music.

**Important Note:** Not all staterooms within each category have the same furniture configuration and/or facilities. Appropriate symbols within the rooms on the deck plans describe differences from the stateroom descriptions below.

All information is subject to change.

#### STATEROOM SYMBOL LEGEND

- Quad (2 lower beds, 1 sofa bed, 1 upper)
- Triple (2 lower beds, 1 sofa bed)
- ▲ 2 lower beds or converts to 1 queen-size
- △ Partial sea view
- × Fully obstructed view
- \* Shower only
- Bathtub & shower
- + Connecting rooms
- ◇ These staterooms have portholes instead of windows

#### ACCESSIBILITY STATEROOM SYMBOL LEGEND

- ♿ Suites AA7061 & AA6223 and stateroom EE3437 are fully accessible, roll-in shower only
- ▼ Suites SB7041 & SB7040 are fully accessible with single side approach to the bed with bathtub & roll-in shower. Staterooms CQ6104, CA3333, CA3331, G1805 & G1804 are fully accessible with single side approach to the bed, roll-in shower only.
- ★ Staterooms HH3439, HH3428, H3399, H3394, E2709, E2704, E2702, L2696, J2555, J2554, G2500, FF1956, FF1943, G1807 & G1806 are ambulatory accessible, roll-in shower only

For more information regarding accessibility features on our ships please visit the [Accessible Cruising](#) section of our website.



Promenade Deck

### DECK 4—PROMENADE DECK

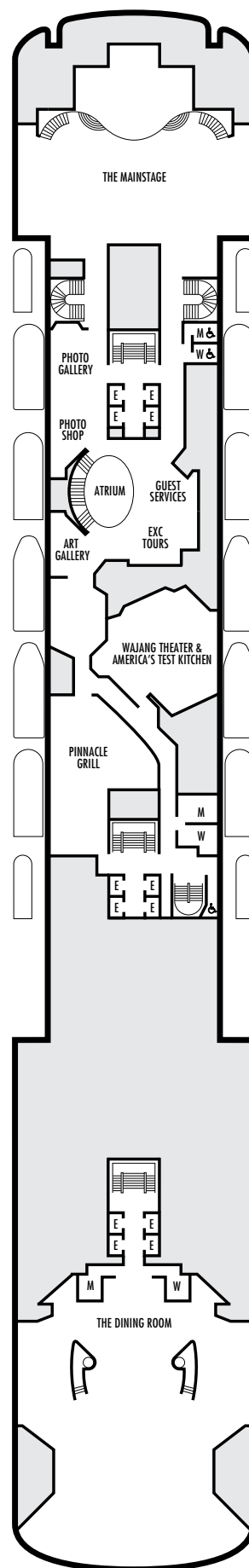

## ROTTERDAM

### DECK PLANS & STATEROOMS

The deck plans are color-coded by category of stateroom, and the category letter precedes the stateroom number in each room. All staterooms are equipped with flat-panel television, DVD player, telephone and multichannel music.

**Important Note:** Not all staterooms within each category have the same furniture configuration and/or facilities. Appropriate symbols within the rooms on the deck plans describe differences from the stateroom descriptions below.

All information is subject to change.

#### STATEROOM SYMBOL LEGEND

- Quad (2 lower beds, 1 sofa bed, 1 upper)
- Triple (2 lower beds, 1 sofa bed)
- ▲ 2 lower beds or converts to 1 queen-size
- △ Partial sea view
- × Fully obstructed view
- \* Shower only
- Bathtub & shower
- + Connecting rooms
- ◇ These staterooms have portholes instead of windows

#### ACCESSIBILITY STATEROOM SYMBOL LEGEND

- ♿ Suites AA7061 & AA6223 and stateroom EE3437 are fully accessible, roll-in shower only
- ▼ Suites SB7041 & SB7040 are fully accessible with single side approach to the bed with bathtub & roll-in shower. Staterooms CQ6104, CA3333, CA3331, G1805 & G1804 are fully accessible with single side approach to the bed, roll-in shower only.
- ★ Staterooms HH3439, HH3428, H3399, H3394, E2709, E2704, E2702, L2696, J2555, J2554, G2500, FF1956, FF1943, G1807 & G1806 are ambulatory accessible, roll-in shower only

For more information regarding accessibility features on our ships please visit the [Accessible Cruising](#) section of our website.



Upper Promenade Deck

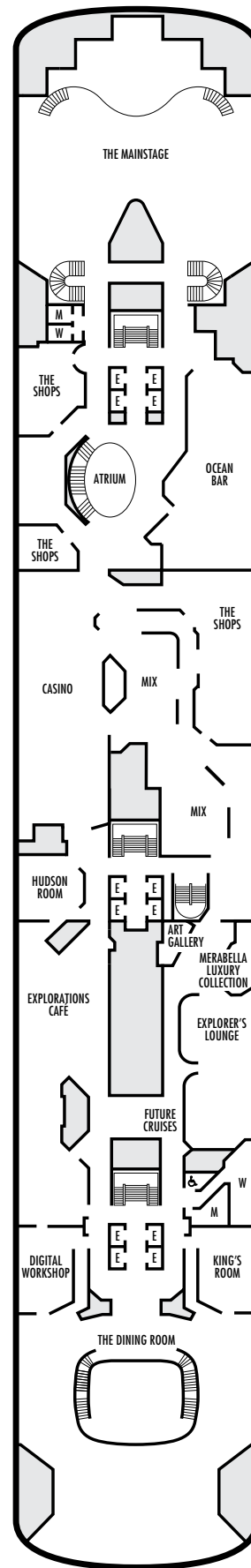

## ROTTERDAM

### DECK PLANS & STATEROOMS

The deck plans are color-coded by category of stateroom, and the category letter precedes the stateroom number in each room. All staterooms are equipped with flat-panel television, DVD player, telephone and multichannel music.

**Important Note:** Not all staterooms within each category have the same furniture configuration and/or facilities. Appropriate symbols within the rooms on the deck plans describe differences from the stateroom descriptions below.

All information is subject to change.

### STATEROOM SYMBOL LEGEND

- Quad (2 lower beds, 1 sofa bed, 1 upper)
- Triple (2 lower beds, 1 sofa bed)
- ▲ 2 lower beds
- △ Partial sea view
- × Fully obstructed view
- \* Shower only
- Bath tub & shower
- + Connecting rooms
- ◇ These staterooms have portholes instead of windows

### ACCESSIBILITY STATEROOM SYMBOL LEGEND

- ♿ Suites AA7061 & AA6223 and stateroom EE3437 are fully accessible, roll-in shower only
- ▼ Suites SB7041 & SB7040 are fully accessible with single side approach to the bed with bathtub & roll-in shower. Staterooms CQ6104, CA3333, CA3331, G1805 & G1804 are fully accessible with single side approach to the bed, roll-in shower only.
- ★ Staterooms HH3439, HH3428, H3399, H3394, E2709, E2704, E2702, L2696, J2555, J2554, G2500, FF1956, FF1943, G1807 & G1806 are ambulatory accessible, roll-in shower only

For more information regarding accessibility features on our ships please visit the [Accessible Cruising](#) section of our website.

### VERANDAH SPA SUITES

#### BQ

**Vista Spa Suites:** 2 lower beds convertible to 1 queen-size bed, whirlpool bath & shower, sitting area, private verandah, mini-bar, refrigerator, floor-to-ceiling windows. Approximately 292 sq. ft. including verandah.

### VERANDAH SUITES

#### A AA B

**Vista Suites:** 2 lower beds convertible to 1 queen-size bed, whirlpool bath & shower, sitting area, private verandah, mini-bar, refrigerator, floor-to-ceiling windows. Approximately 295–337 sq. ft. including verandah.

### OCEAN-VIEW STATEROOMS

#### CQ

**Large Ocean-view Spa:** 2 lower beds convertible to 1 queen-size bed, bathtub & shower. Approximately 140–319 sq. ft.

### INTERIOR STATEROOMS

#### I K

**Large:** 2 lower beds convertible to 1 queen-size bed, shower. Approximately 182–293 sq. ft.

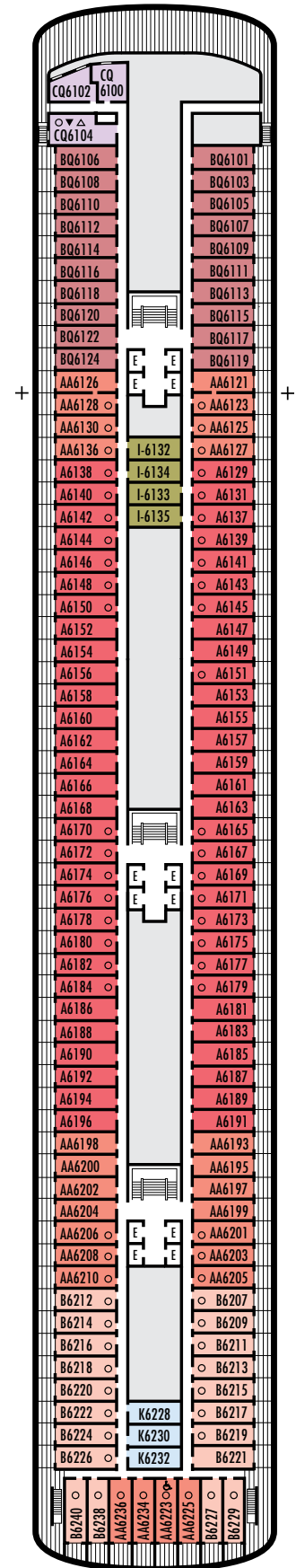

Verandah Deck

## ROTTERDAM

### DECK PLANS & STATEROOMS

The deck plans are color-coded by category of stateroom, and the category letter precedes the stateroom number in each room. All staterooms are equipped with flat-panel television, DVD player, telephone and multichannel music.

**Important Note:** Not all staterooms within each category have the same furniture configuration and/or facilities. Appropriate symbols within the rooms on the deck plans describe differences from the stateroom descriptions below.

All information is subject to change.

### STATEROOM SYMBOL LEGEND

- Quad (2 lower beds, 1 sofa bed, 1 upper)
- Triple (2 lower beds, 1 sofa bed)
- ▲ 2 lower beds or converts to 1 queen-size
- △ Partial sea view
- × Fully obstructed view
- \* Shower only
- Bathtub & shower
- + Connecting rooms
- ◇ These staterooms have portholes instead of windows

### ACCESSIBILITY STATEROOM SYMBOL LEGEND

- ♿ Suites AA7061 & AA6223 and stateroom EE3437 are fully accessible, roll-in shower only
- ▼ Suites SB7041 & SB7040 are fully accessible with single side approach to the bed with bathtub & roll-in shower. Staterooms CQ6104, CA3333, CA3331, G1805 & G1804 are fully accessible with single side approach to the bed, roll-in shower only.
- ★ Staterooms HH3439, HH3428, H3399, H3394, E2709, E2704, E2702, L2696, J2555, J2554, G2500, FF1956, FF1943, G1807 & G1806 are ambulatory accessible, roll-in shower only

For more information regarding accessibility features on our ships please visit the [Accessible Cruising](#) section of our website.

### VERANDAH SUITES

#### PS

**Pinnacle Suites:** Bedroom with 1 king-size bed, oversize whirlpool bath & shower, living room, dining room, dressing room, private verandah, pantry, 1 sofa bed for 2 persons, mini-bar, refrigerator, guest toilet, floor-to-ceiling windows. Approximately 1,181 sq. ft. including verandah.

#### SA SB

**Neptune Suites:** 2 lower beds convertible to 1 king-size bed, whirlpool bath & shower, large sitting area, dressing room, private verandah, 1 sofa bed for 2 persons, mini-bar, refrigerator, floor-to-ceiling windows. Approximately 568–644 sq. ft. including verandah.

#### AA B BB BC

**Vista Suites:** 2 lower beds convertible to 1 queen-size bed, whirlpool bath & shower, sitting area, private verandah, mini-bar, refrigerator, floor-to-ceiling windows. Approximately 292 sq. ft. including verandah.

### INTERIOR STATEROOMS

#### K

**Large:** 2 lower beds convertible to 1 queen-size bed, shower. Approximately 182–293 sq. ft.

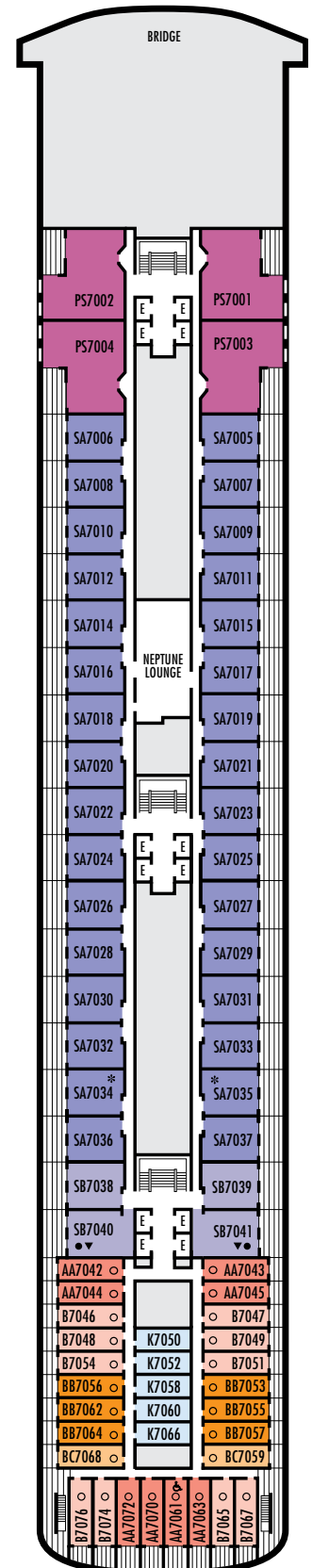

Navigation Deck



## ROTTERDAM

### DECK PLANS & STATEROOMS

The deck plans are color-coded by category of stateroom, and the category letter precedes the stateroom number in each room. All staterooms are equipped with flat-panel television, DVD player, telephone and multichannel music.

**Important Note:** Not all staterooms within each category have the same furniture configuration and/or facilities. Appropriate symbols within the rooms on the deck plans describe differences from the stateroom descriptions below.

All information is subject to change.

#### STATEROOM SYMBOL LEGEND

- Quad (2 lower beds, 1 sofa bed, 1 upper)
- Triple (2 lower beds, 1 sofa bed)
- ▲ 2 lower beds or converts to 1 queen-size
- △ Partial sea view
- × Fully obstructed view
- \* Shower only
- Bathtub & shower
- + Connecting rooms
- ◇ These staterooms have portholes instead of windows

#### ACCESSIBILITY STATEROOM SYMBOL LEGEND

- ♿ Suites AA7061 & AA6223 and stateroom EE3437 are fully accessible, roll-in shower only
- ▼ Suites SB7041 & SB7040 are fully accessible with single side approach to the bed with bathtub & roll-in shower. Staterooms CQ6104, CA3333, CA3331, G1805 & G1804 are fully accessible with single side approach to the bed, roll-in shower only.
- ★ Staterooms HH3439, HH3428, H3399, H3394, E2709, E2704, E2702, L2696, J2555, J2554, G2500, FF1956, FF1943, G1807 & G1806 are ambulatory accessible, roll-in shower only

For more information regarding accessibility features on our ships please visit the [Accessible Cruising](#) section of our website.



Lido Deck

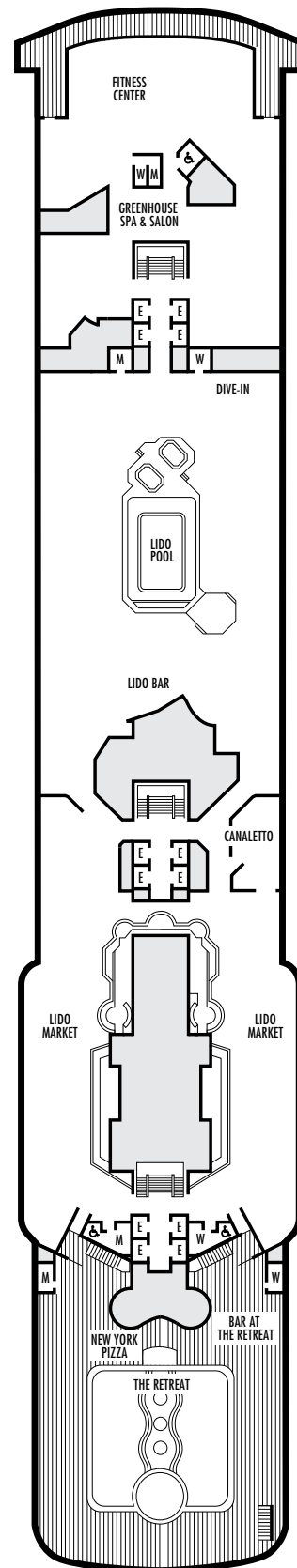



## ROTTERDAM

### DECK PLANS & STATEROOMS

The deck plans are color-coded by category of stateroom, and the category letter precedes the stateroom number in each room. All staterooms are equipped with flat-panel television, DVD player, telephone and multichannel music.

**Important Note:** Not all staterooms within each category have the same furniture configuration and/or facilities. Appropriate symbols within the rooms on the deck plans describe differences from the stateroom descriptions below.

All information is subject to change.

#### STATEROOM SYMBOL LEGEND

- Quad (2 lower beds, 1 sofa bed, 1 upper)
- Triple (2 lower beds, 1 sofa bed)
- ▲ 2 lower beds or converts to 1 queen-size
- △ Partial sea view
- × Fully obstructed view
- \* Shower only
- Bathtub & shower
- + Connecting rooms
- ◇ These staterooms have portholes instead of windows

#### ACCESSIBILITY STATEROOM SYMBOL LEGEND

- ♿ Suites AA7061 & AA6223 and stateroom EE3437 are fully accessible, roll-in shower only
- ▼ Suites SB7041 & SB7040 are fully accessible with single side approach to the bed with bathtub & roll-in shower. Staterooms CQ6104, CA3333, CA3331, G1805 & G1804 are fully accessible with single side approach to the bed, roll-in shower only.
- ★ Staterooms HH3439, HH3428, H3399, H3394, E2709, E2704, E2702, L2696, J2555, J2554, G2500, FF1956, FF1943, G1807 & G1806 are ambulatory accessible, roll-in shower only

For more information regarding accessibility features on our ships please visit the [Accessible Cruising](#) section of our website.

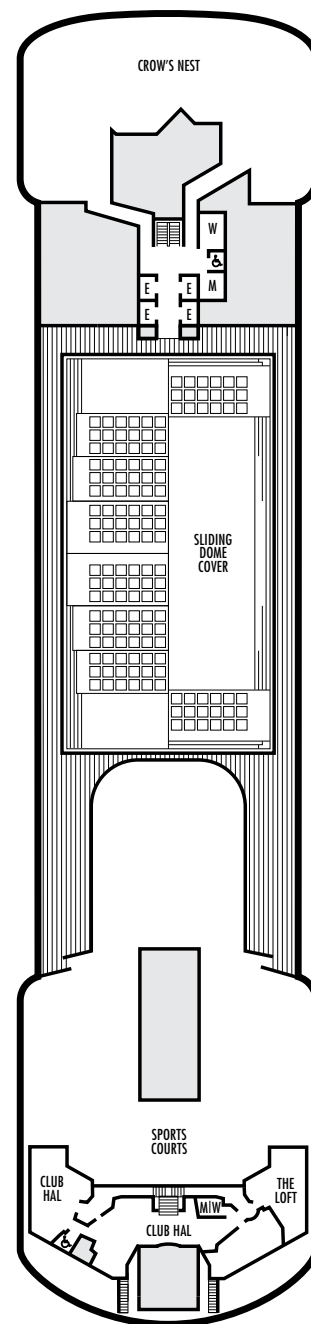

Sports Deck

